

CLEWER[®]
clean water

TECHNICAL DESCRIPTION

Wastewater treatment for 2,000–2,800 people

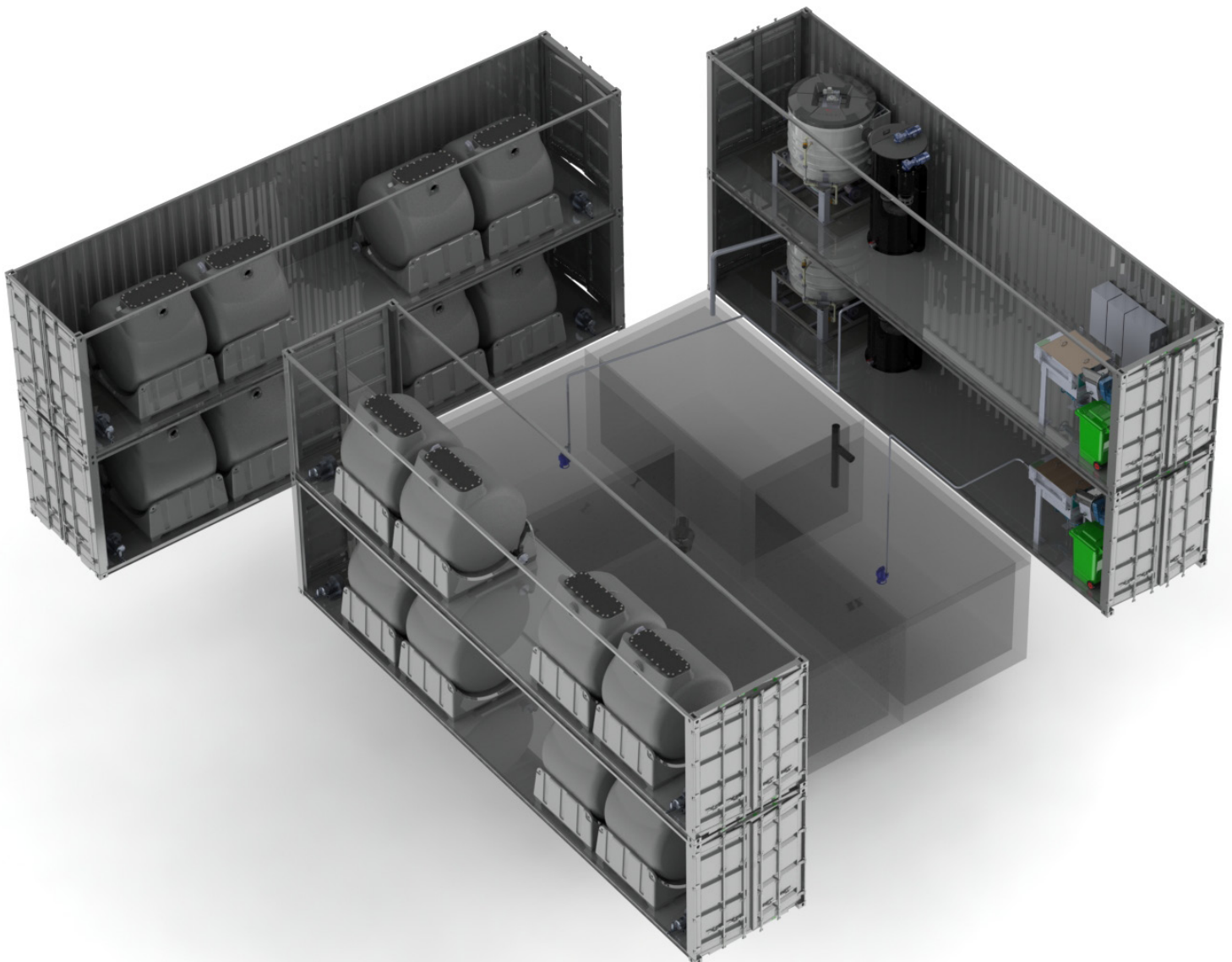

System components

*Insulated container. The plant can also be assembled inside an existing building without containers.

Unit process	Device	Number of devices
Plant frame	40' container*	6
Pre-screening	Pre-screening device	2
BOD removal & nitrification	Clewer R4000 bioreactor	16
Aeration	Side channel blowers	8
Precipitation	Chemical mixing station & Clewer flocculation unit FL-1000	2
Solid-liquid separation	Clewer flotation unit F-2900	2
Electricity + automation	Distribution central	1
Installation + accessories	Components installed to the containers	1
pH measurement	pH sensor + accessories	2 (1 spare)
Level measurement	Level sensor	3 (1 spare)
Chemical dosing	Dosing pumps + accessories	4
Chemical dosing	Controller	1
Pressurized air	Air compressor	1

Power consumption

Device	Pc	Power [kW]	Total power [kW]
Pre-screening device	2	1.1	2.2
Mixer	2	~2.5	~5.0
Pump	8	~1.1	~8.8
Pump	2	~2.4	~4.8
Clewer flotation unit F-2900	2	1.7	3.4
Chemical mixing station & Clewer flocculation unit FL-1000	2	0.7	1.4
Side channel blowers	8	4.0	32.0
Air compressor	1	1.1	1.1
Dosing pumps + accessories	Σ	0.2	0.2
Total power demand [kW]			58.9
Total continuous power demand [kW]			50.6

Consumables

pH adjustment	Sodium hydroxide	20-40g/m ³
Flocculation	Polyaluminium chloride	80-150ml/m ³
Denitrification	Ethanol (or other equivalent carbon source)	50-100ml/m ³

Clewer provides patented and ecological wastewater treatment systems for industry and communities worldwide.

Contact us!

info@clewer.com, www.clewer.com

CLEWER
clean water