

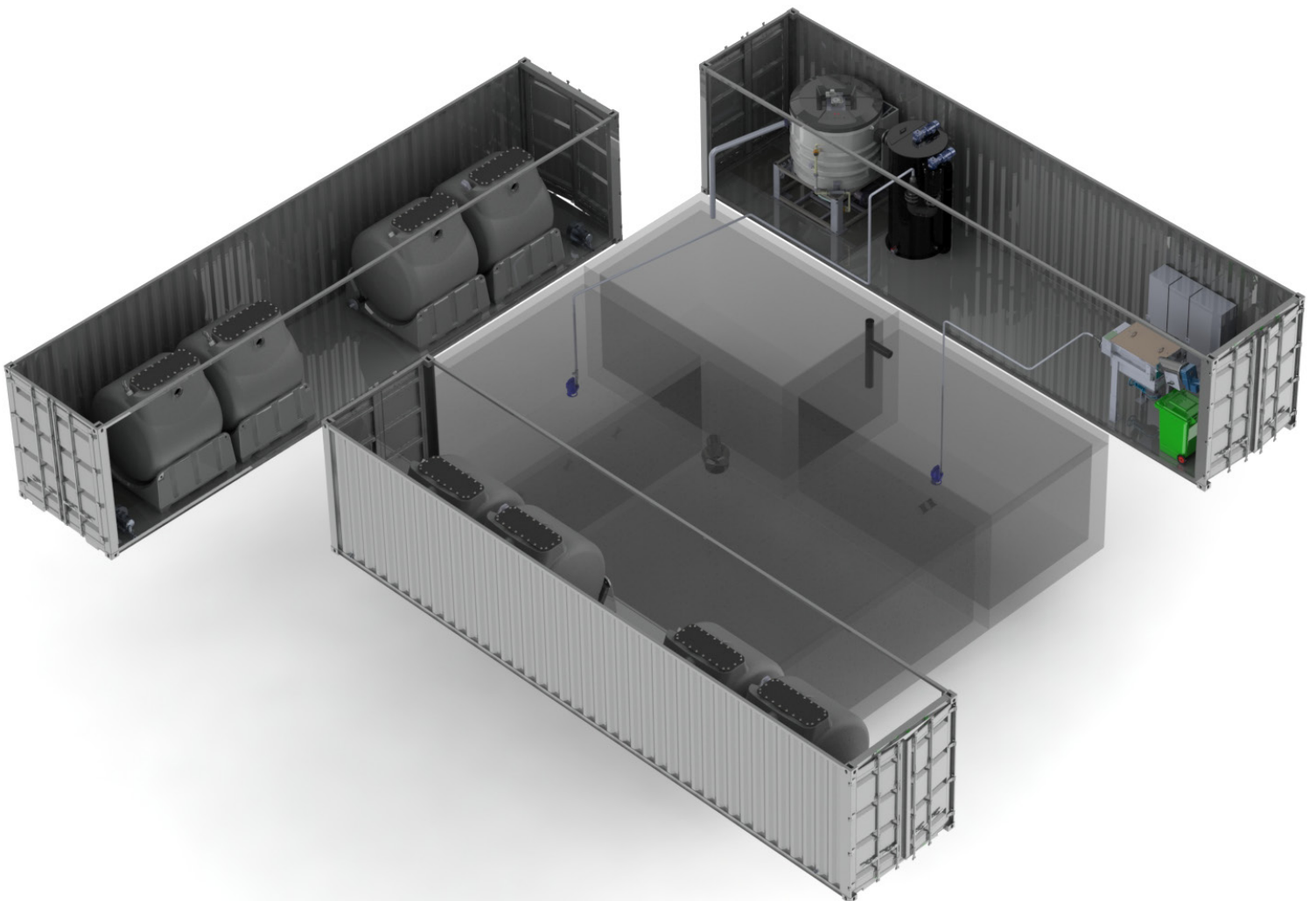

TECHNICAL DESCRIPTION

Wastewater treatment for 1,000-1,400 people



System components

*Insulated container. The plant can also be assembled inside an existing building without containers.

Unit process	Device	Number of devices
Plant frame	40' container*	3
Pre-screening	Pre-screening device	1
BOD removal & nitrification	Clewer R4000 bioreactor	8
Aeration	Side channel blowers	4
Precipitation	Chemical mixing station & Clewer flocculation unit FL-1000	1
Solid-liquid separation	Clewer flotation unit F-2900	1
Electricity + automation	Distribution central	1
Installation + accessories	Components installed to the containers	1
pH measurement	pH sensor + accessories	2 (1 spare)
Level measurement	Level sensor	3 (1 spare)
Chemical dosing	Dosing pumps + accessories	3
Chemical dosing	Controller	1
Pressurized air	Air compressor	1

Power consumption

Device	Pc	Power [kW]	Total power [kW]
Pre-screening device	1	1.1	1.1
Mixer	2	~1.5	~3.0
Pump	4	~1.1	~4.4
Pump	1	~2.4	~2.4
Clewer flotation unit F-2900	1	1.7	1.7
Chemical mixing station & Clewer flocculation unit FL-1000	1	0.7	0.7
Side channel blowers	4	4.0	16.0
Air compressor	1	1.1	1.1
Dosing pumps + accessories	Σ	0.1	0.1
Total power demand [kW]			30.5
Total continuous power demand [kW]			25.8

Consumables

pH adjustment	Sodium hydroxide	20-40g/m ³
Flocculation	Polyaluminium chloride	80-150ml/m ³
Denitrification	Ethanol (or other equivalent carbon source)	50-100ml/m ³

Clewer provides patented and ecological wastewater treatment systems for industry and communities worldwide.

Contact us!

info@clewer.com, www.clewer.com

CLEWER
clean water